

# 1 Contents

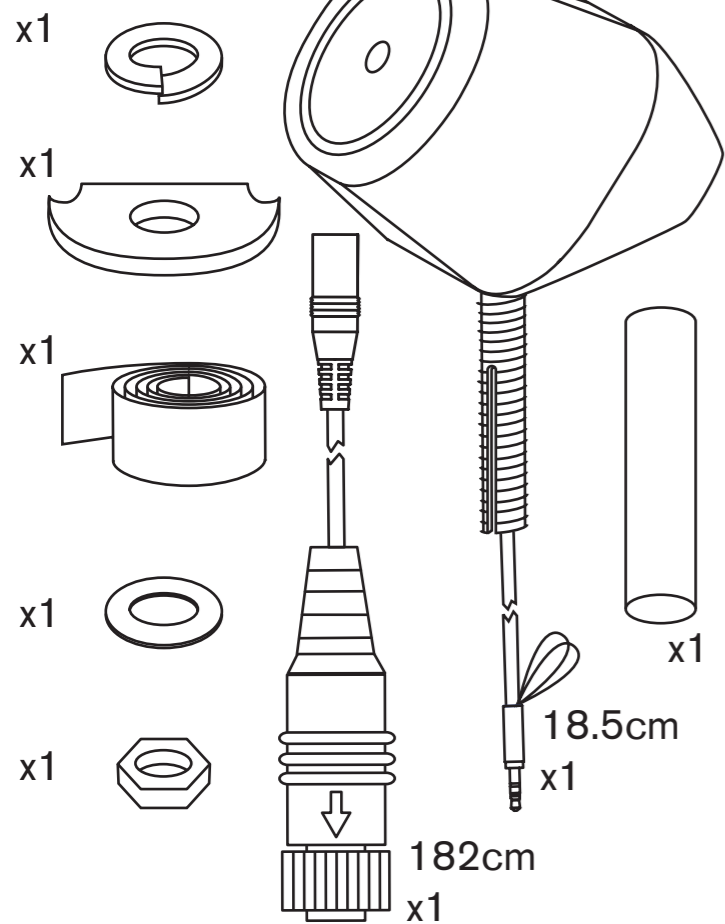

# 2 Tools Required

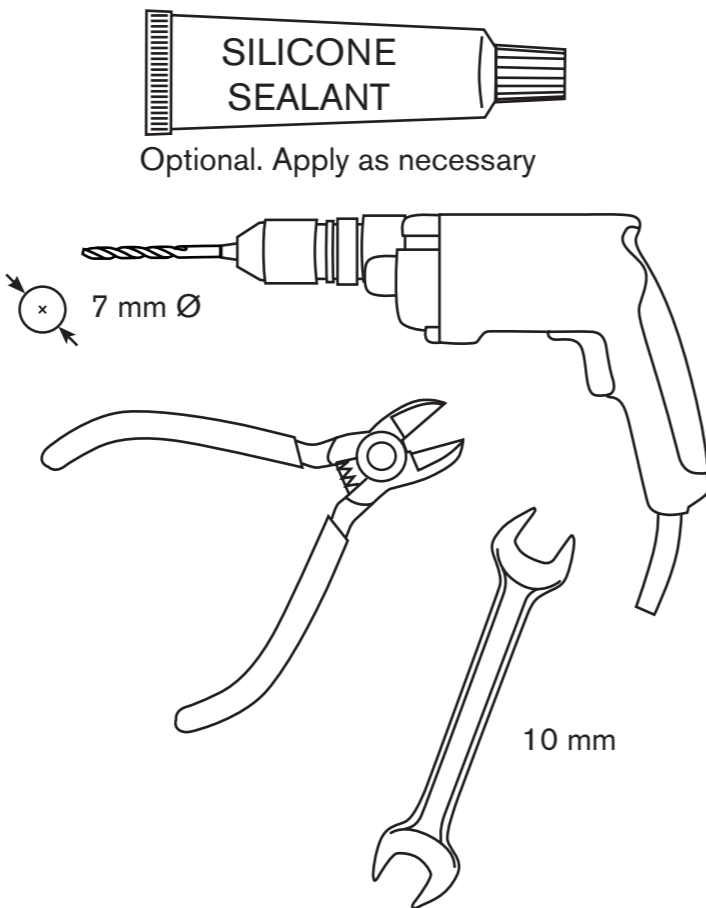

# 3 Assembly & Connections

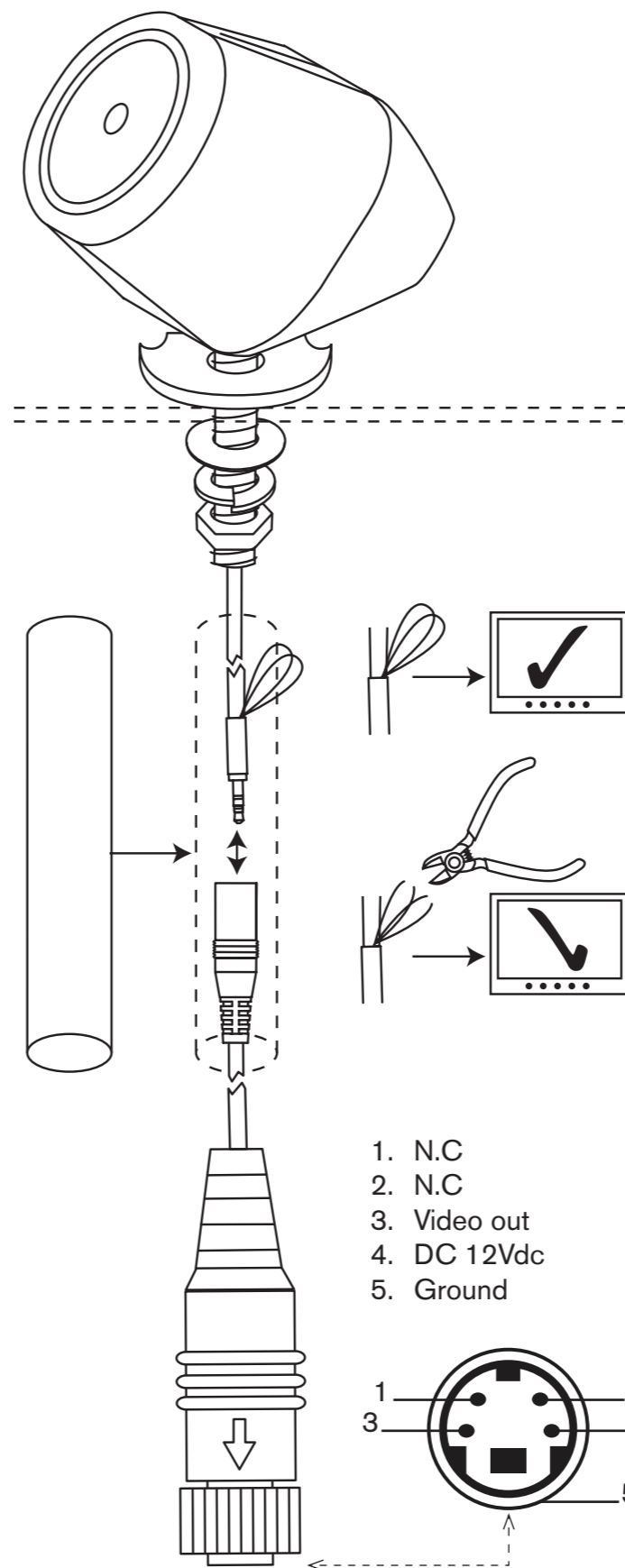

Specifications	
Pick-UP device	Sharp 1/4" CCD
Picture Elements (PAL)	512 (h) x 582 (V)
Image Size	1/4 inch
Synchronisation	Internal
Horizontal Illumination	380 TV Line
Lens Focal Length	1.65 mm
Signal to Noise Ratio	More than 42db
Required Illumination	0.1 Lux
Voltage Supply	12 Vdc ± 2 Vdc
Power Consumption	<0.85 Watts @ 12 Vdc
Maximum Aperture	2.0mm ± 5%
Current Consumption	65mA @ 12 Vdc
Viewing Angle	122° (H), 94° (V), 154° ± 5°(D)
Operating Temperature	-25°C to +80°C
Storage Temperature	-40°C to +90°C
Weight	80 Grams (without cable adaptor)
Overall Dimensions (mm)	34 (W), 37 (D), 24 (H)
Video Output	1.0 Vp-p/75 Ω
Length of Cable	2000mm
Vibration Rating	10G
IP Rating of Connector	N/A
IP Rating of Housing	IP68
Casing Mounting Thread	M6

Specifications subject to change.



# BE-500 Series Colour Flush-Mount Cameras

## Installation Guide

# 4 Vertical Mount

BE-500VC

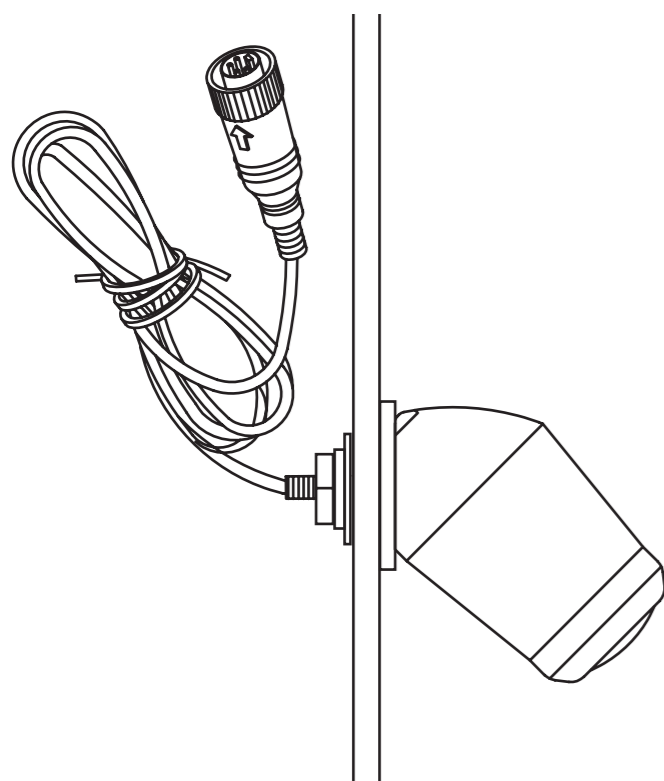

# 5 Horizontal Mount

BE-500HC

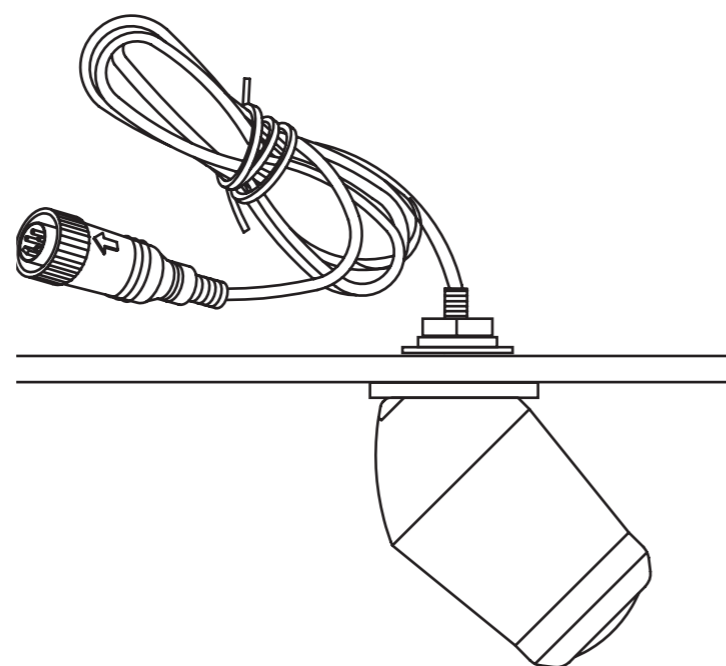

The BE-500 series cameras are an invaluable driver aid but does not exempt the driver from taking every normal precaution when conducting a manoeuvre. No liability arising out of the use or failure of the product can in any way be attached to Brigade or to the distributor.

Original Equipment Manufacture bodybuilder guide or aftermarket installation guidelines must be followed when installing this product. Failure to comply with this may invalidate the vehicles warranty.

